

2 ND. FLOOR PLAN

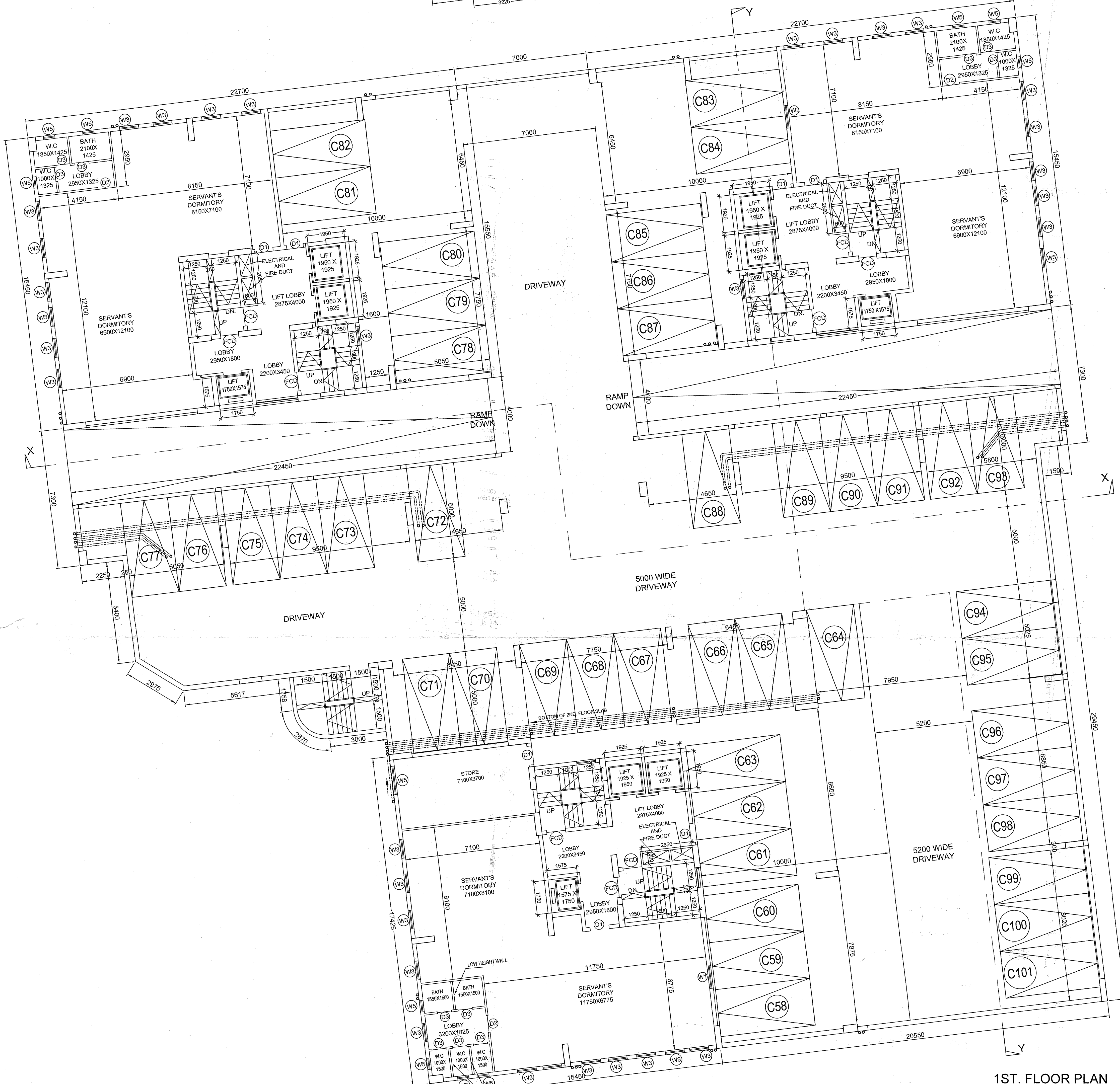

1ST. FLOOR PLAN

**SPECIFICATION**  
 R.C.C. FRAME STRUCTURE WITH CONC. GRADE 1:1.5:3.  
 200 MM THK. EXTERNAL, 100 & 75 MM THK. INTERNAL WALLS WITH  
 1:4 CEMENT MORTAR JOINTS  
 ALUMINIUM CASEMENT WINDOWS.  
 CAST-IN-SITU MOSAIC FLOORING.  
 18 & 14 CEMENT PLASTER ON INTERNAL WALLS AND CEILING RESPECTIVELY.  
 WATER PROOFING TREATMENT.  
 P.O.P. PLANNING ON INTERNAL WALLS & CEILING.

**SCHEDULE OF DOORS**

NO.	TYPE	SIZE	SILL HEIGHT	LINTEL HEIGHT	REMARKS
1)	D1	1000 X 2100	900	2100	
2)	D2	900 X 2100	900	2100	
3)	D3	350 X 2100	1150	2100	
4)	SD1	3600 X 2100	2100	2100	
5)	SD2	2400 X 2100	2100	2100	
6)	SD3	1500 X 2100	2100	2100	
7)	FCD	1000 X 2100	2100	2100	FIRE DOOR

**SCHEDULE OF WINDOWS**

NO.	TYPE	WIDTH	SILL HEIGHT	LINTEL HEIGHT	REMARKS
1)	W1	1500 X 1200	900	2100	
2)	W2	1200 X 1200	900	2100	
3)	W3	1000 X 1200	900	2100	
4)	W4	600 X 1000	1100	2100	
5)	W5A	400 X 1000	1150	2100	
6)	W5	600 X 900	1200	2100	

**ALOK ROY**  
 B.E. (CIVIL), M.E. (STRUCTURE)  
 Registered Professional Engineer  
 No. 008 / C.T. Eng., Class-I

ALOK ROY  
 GEOTECH ENGINEERS PVT. LTD.  
 SIGNATURE OF GEO-TECHNICAL ENGINEER

**DECLARATION OF STRUCTURAL ENGINEER**  
 THE STRUCTURAL DESIGN OF BOTH FOUNDATION AND SUPERSTRUCTURE OF THE BUILDING HAVE BEEN MADE BY ME CONSIDERING ALL POSSIBLE LOADS INCLUDING THE SEISMIC LOAD AS PER B.C.O.F INDIA AND BASIS OF SOIL INVESTIGATION REPORT BY GEOTECH ENGINEERS PVT. LTD. (MR. ALOK ROY) SA, MILAN PARK, KOLKATA-700064. CERTIFY THAT IT IS SAFE AND STABLE IN ALL RESPECT.

**K. Sengupta**  
 KUSHIK SENGUPTA  
 B.E. (CIVIL), M.E. (STRUCTURE)  
 Registered Professional Engineer  
 No. 1799 (C.T. Eng.)

KUSHIK SENGUPTA  
 B.E. (CIVIL), M.E. (STRUCTURE)  
 No. 1799 (C.T. Eng.)  
 SIGNATURE OF STRUCTURAL ENGINEER & SEAL

**DECLARATION OF ARCHITECT**  
 CERTIFIED THAT THE PLAN ITSELF WITH FULL RESPONSIBILITY THAT THE BUILDING PLAN HAS DRAWN UP AS PER PROVISION OF K.M.C. BUILDING RULES 2006 AS AMENDED FROM TIME TO TIME AND THE SITE CONDITION INCLUDING THE ABUTTING ROAD IS CONFORM WITH THE PLAN. IT IS A BUILDABLE SITE NOT A TANK OR FILLED UP TANK. THERE IS AN EX. STRUC. TO BE DEMOLISHED BEFORE COMMENCEMENT OF WORK IT IS FULLY OCCUPIED BY THE OWNER. THERE IS NO TENANT.

**MALAY KUMAR GHOSH**  
 Regn. No. CA29214584  
 35A, Dr. Sarat Banerjee Road  
 Kolkata - 700 029

MALAY KUMAR GHOSH  
 Regn. No. CA29214584  
 35A, Dr. Sarat Banerjee Road, Kolkata-700 029  
 SIGNATURE OF ARCHITECT & SEAL

**DECLARATION OF OWNER**  
 I DO HEREBY DECLARE WITH FULL RESPONSIBILITY THAT I SHALL ENGAGE L.B.A & E.S.E DURING CONSTRUCTION. I SHALL FOLLOW THE INSTRUCTION OF L.B.A & E.S.E DURING CONSTRUCTION OF THE BUILDING (AS PER PLAN) K.M.C. AUTHORITY WILL NOT BE RESPONSIBLE FOR STRUCTURAL STABILITY OF THE BUILDING & ADJOINING STRUCTURE IF ANY SUBMITTED DOCUMENT ARE FAKE. THE K.M.C. AUTHORITY WILL REVOKE THE SANCTION PLAN. THE CONSTRUCTION OF U.G.W.R & SEPTIC TANK TAKEN UNDER THE GUIDANCE OF LBSBE BEFORE STARTING OF BUILDING FOUNDATION.

**For VENUS COMPLEX PVT. LTD.**  
**Prasenjit**  
 Director  
 VENUS COMPLEX PVT. LTD.  
 SIGNATURE OF OWNER

**TITLE**  
 1 ST. & 2 ND. FLOOR PLAN

**PROJECT**  
 PROPOSED G +12 TH. STORED (HT. = 39.925 MT.)  
 RESIDENTIAL BUILDING U/S 393 A OF K.M.C. ACT 1980  
 AT PREMISES NO- 18 GOBRA GORISTHAN ROAD,  
 KOLKATA - 700046, WARD NO. 59, BOROUGH : VII

**ARCHITECT**  
  
**ESPACE**  
 35-A, DR. SARAT BANERJEE ROAD, KOLKATA-700029  
 Tele/Fax : 91-33-2465-4130 / 4159  
 e-mail : espace@vsnl.net  
 WEBSITE : www.espaceindia.com

JOB NO.	DESIGN BY	DEALT BY	DATE	DRG. NO.
	M.G	SUBRATA	22.03.2016	ARCH / MMC -02

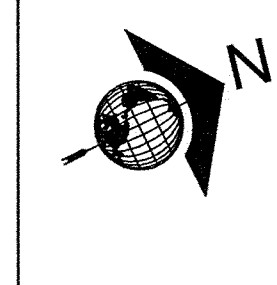

SCALE -1:100